

How to install your Neutron Components Hitchhiker

We've made the Hitchhiker as simple as we can, but appreciate that not everyone's an engineer. With that in mind we thought we'd better put together some instructions to install the Hitchhiker to your bike's accessory mount or bottle cage holes.

STEP 1

Insert the plastic tailstock into the aluminium shell

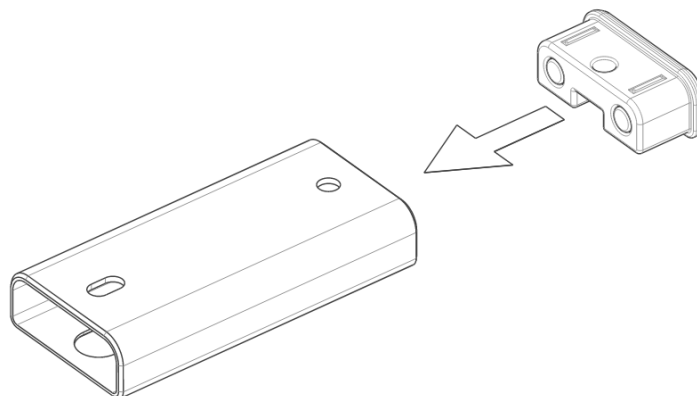

STEP 2

Use the button head screws to install the shell to your bike frame with the plastic tailstock at the rear. If you intend to use the Hitchhiker with a strap – for example to carry a spare inner tube – then use the included spacers to create clearance between the shell and your bike frame.

If installing the Air Tag model, slide the air tag into the slot in the tailstock before installing.

Note: the longer button head screw should be installed through the tailstock and the shorter screw at the front.

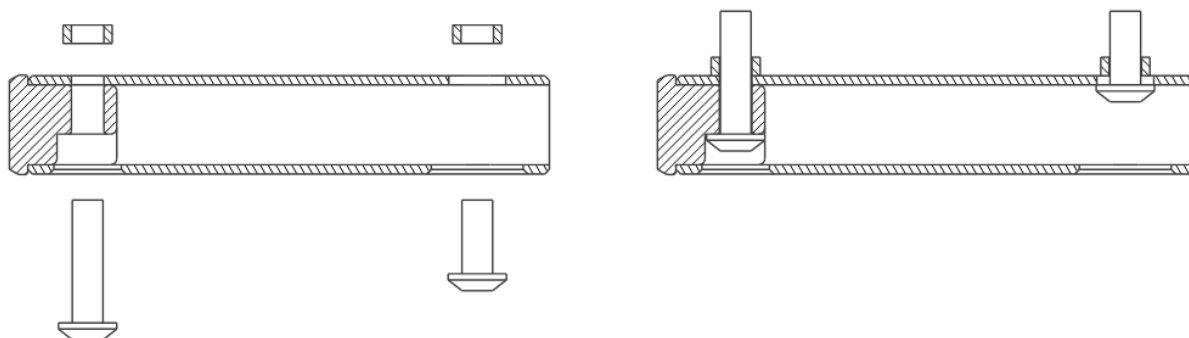

STEP 3A / spare part holder

Load your preferred spare parts into the tray:

Quick links

Insert the pin of your quick links into the holes provided; the integrated magnets will do the rest.

Valve core

Drop your Presta or Schrader valve core into the hole pictured below, then wind in the grub screw until it contacts the valve core. Do not overtighten, a gentle pressure is all that's required to secure the valve core and prevent it from rattling.

Brake pads

Sandwich the pads and spreader-spring together then slide them into the slot on the side of the tray. The spring will keep them snug – if you don't have a spring then we'd recommend a thin piece of card or folded paper to keep it tight.

Pro tip: store your pads in a small plastic bag to keep them from rusting in humid conditions.

Magnetic locking screws

Install the countersunk screws into the holes provided at the rear of the tray. These screws act as a magnetic lock to keep the tray secured inside the shell and can also be used as a replacement SPD screw in a pinch.

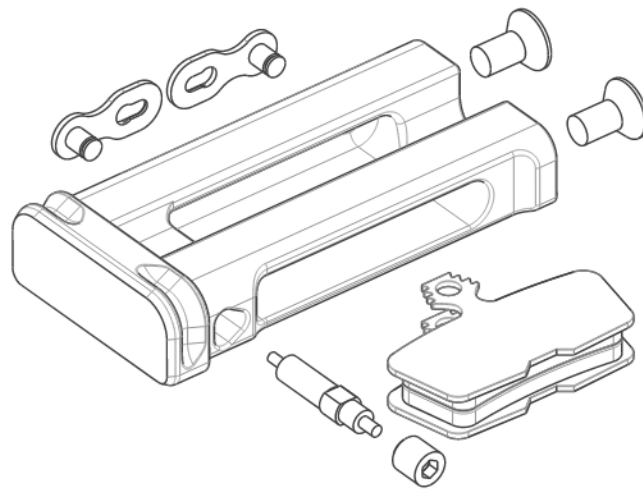

STEP 3B / multitool holder

Multitool

Slide the tool into the slot provided.

8mm hex adapter

Gently press the 8mm adapter into the hexagonal slot at the back of the tray. The magnet will hold it safely in place and prevent it from rattling.

Magnetic locking screw

Install the countersunk screws into the hole provided at the rear of the tray. This screw acts as a magnetic lock to keep the tray secured inside the shell, and can also be used as a replacement SPD screw in a pinch.

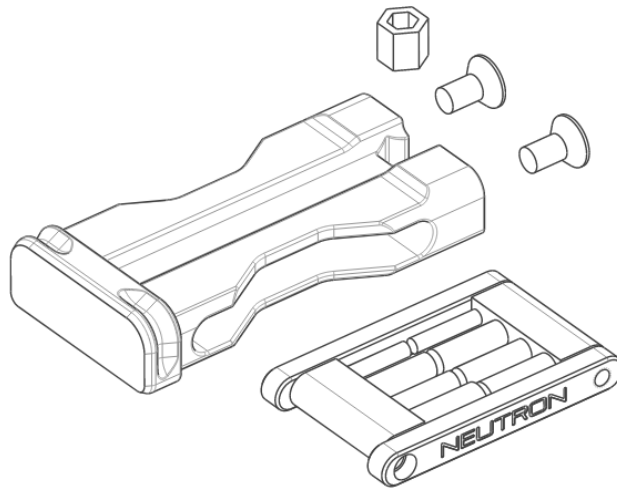

STEP 3C / Air tag

Quick links

Insert the pin of your quick links into the holes provided; the integrated magnets will do the rest.

Valve core

Drop your Presta or Schrader valve core into the hole pictured below, then wind in the grub screw until it contacts the valve core. Do not overtighten, a gentle pressure is all that's required to secure the valve core and prevent it from rattling.

Magnetic locking screws

Install the countersunk screws into the holes provided at the rear of the tray. These screws act as a magnetic lock to keep the tray secured inside the shell and can also be used as a replacement SPD screw in a pinch.

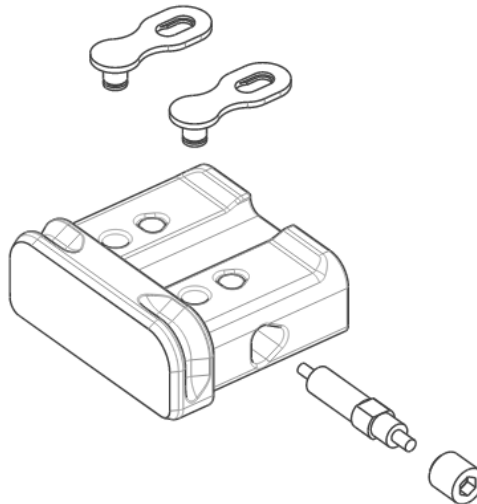

STEP 4

Slide the tray into the shell – you should feel the magnetic lock snap into place.

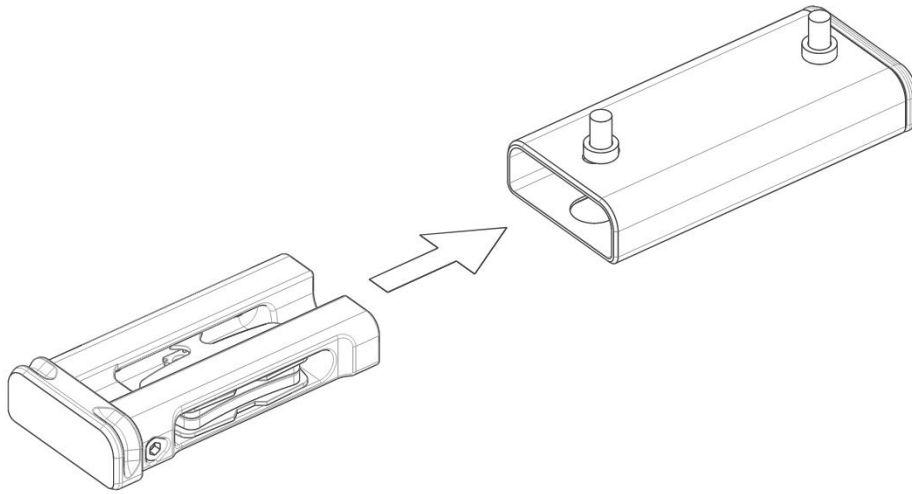

STEP 5 / optional

Strap a tube on that bad boy. If using a Voile strap then we recommend pre-fitting the strap and keeper as shown in the image below *before* positioning the inner tube.

